



## KEY FEATURES

- 1 Oversized Drive-In Door (18'W x 14'H)
- Well-located in an established industrial park
- 14'8" clear height
- Sublease available through 10/31/2025
- ±9,000 SF; units A-C
- 3 dock doors (8' x 10')
- Fully conditioned warehouse space
- Large outdoor storage / parking area
- \$8.00 PSF NNN

INDUSTRIAL - 9,000 SF

SUBLEASE | \$8.00 PSF NNN

# SOUTH ELM INDUSTRIAL CENTER SUBLEASE

205 Creek Ridge Road, Suites A-C  
Greensboro, NC 27406

Excellent opportunity to lease warehouse space in one of Greensboro's premier industrial parks. The property provides convenient access to I-40 and access to multiple loading docks.

## LEARN MORE ABOUT THIS PROPERTY

### STEVE VALLOS

steve@commercialrealtync.com  
336.793.0890, ext 105

### HOUSTON HOUGH

houston@commercialrealtync.com  
336.793.0890, ext 206





## SOUTH ELM INDUSTRIAL CENTER SUBLEASE

### LOCATION

<b>Address</b>	205 Creek Ridge Road, Suites A-C		<b>City</b>	Greensboro	
<b>State</b>	NC	<b>Zip</b>	27406	<b>County</b>	Guilford

### PROPERTY DETAILS

<b>Property Type</b>	Industrial	<b>Avail SF ±</b>	9,000	<b>Office SF ±</b>	1,902
<b>Docks ±</b>	3 (8' x 10')	<b>Drive Ins ±</b>	1 (18' W x 14'H)		

### TAX INFORMATION

<b>Zoning</b>	LI (Light Industrial)	<b>Tax PIN</b>	7863-40-8273
---------------	-----------------------	----------------	--------------

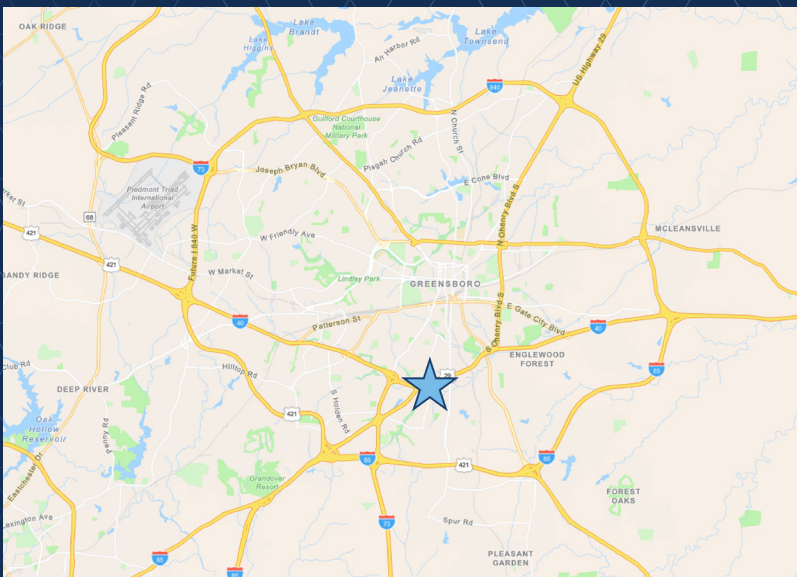
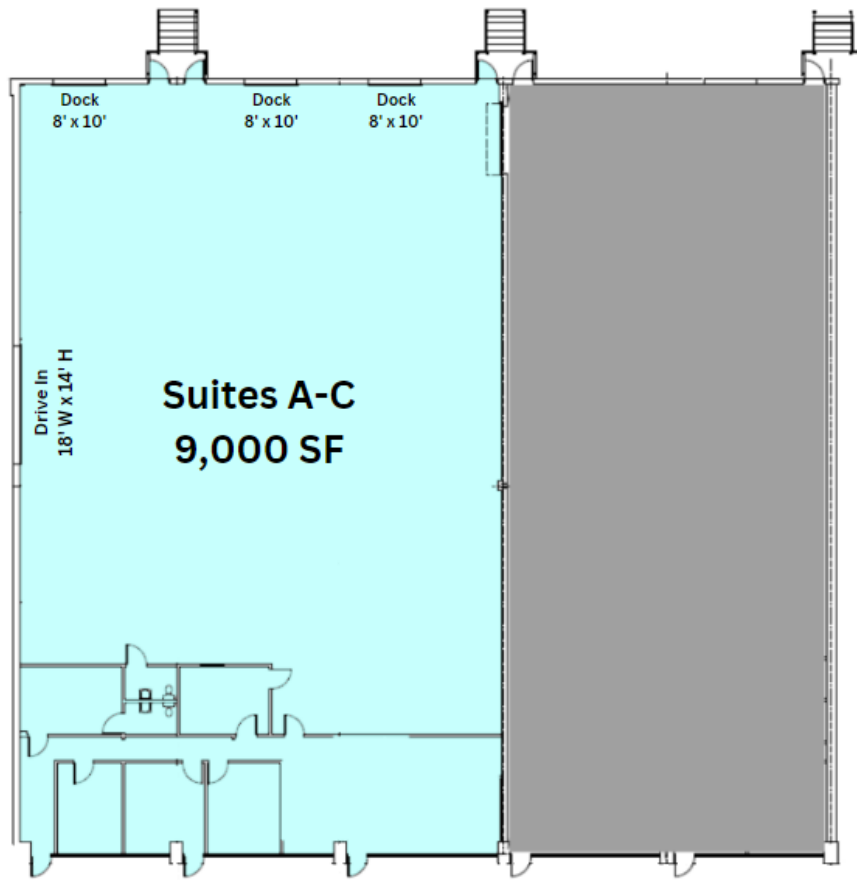

## LOCATION FEATURES

- Close proximity to I-40
- Located in the Randleman Road / S Elm-Eugene Street corridor in southern Greensboro